

NOTE : THE FOOTPRINTS OF ADJOINING PROPERTIES ARE TAKEN FROM THE MOST CURRENT OS MAP PROVIDED TO THE ARCHITECT

OSi Licence No.: CYAL50273835
© Copyright Ordnance Survey Ireland/Government of Ireland

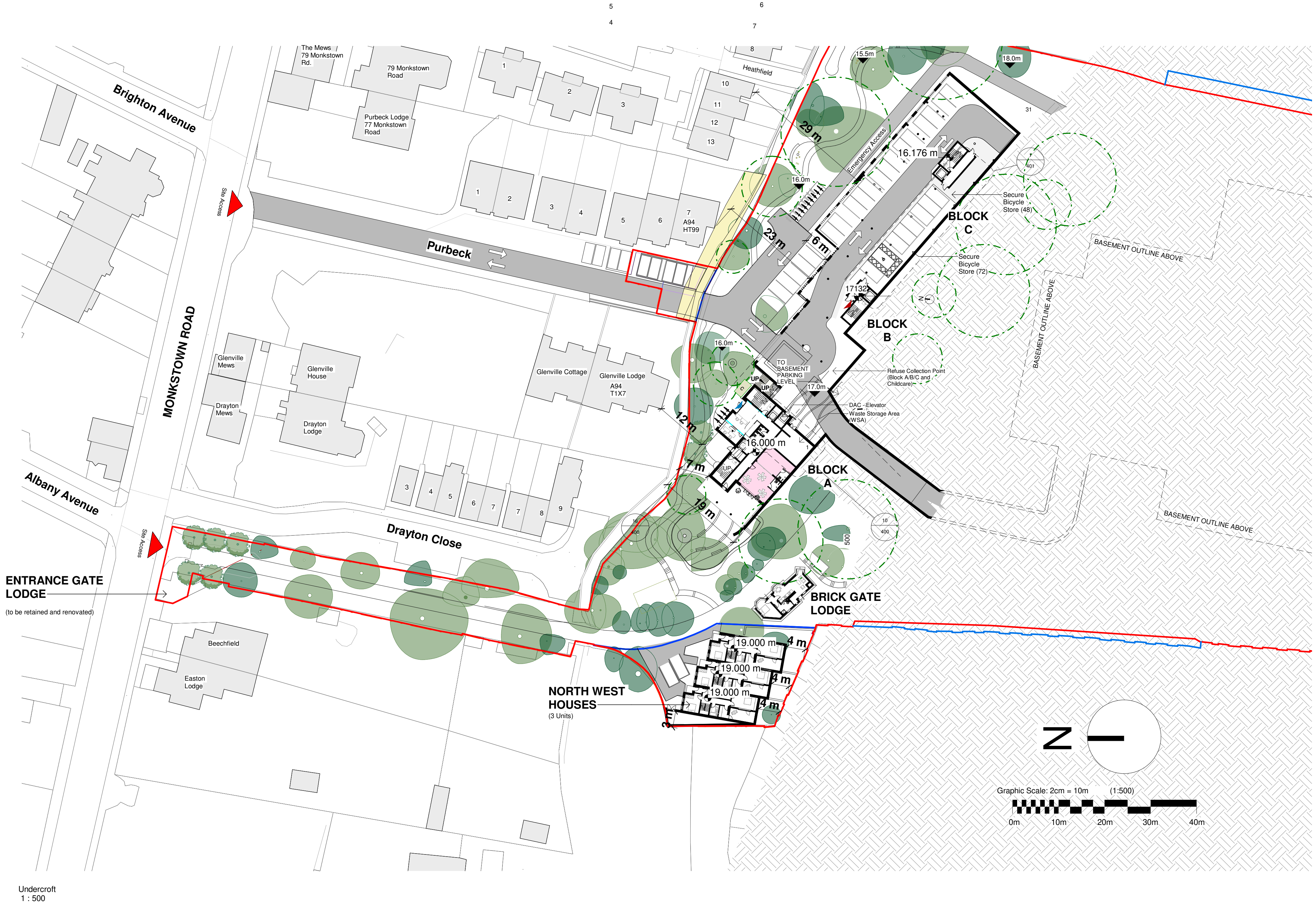
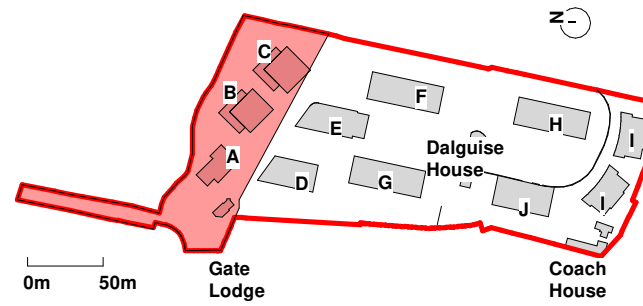

Undercroft
1 : 500

Notes:
- Do not scale from this drawing. Use figured dimensions in all cases.
- Verify dimensions on site and report any discrepancies to the Architect immediately.
- This drawing to be read in conjunction with the Architect's Specification.
- © This drawing is copyright and may only be reproduced with the Architect's permission.

Drawing Notes:

COPYRIGHT:
OSi Licence No.: CYAL50273835
© Copyright Ordnance Survey Ireland/Government of Ireland

- Indicates Extent of Application
- Site Area within Application = 35,267.1 m²
- Indicates Adjacent Site in Ownership of Applicant
- Wayleave
- Part V Allocation
- Waste Storage Area
- Access / Connection to surrounding Neighbourhoods.
- Site Access

Issues & Revisions			
Revision Number	Date	Drawn	Details of Issue / Revision
P01	12.10.22		Issued for Planning



W: www.reddyarchitecture.com
E: info@reddyarchitecture.com

Client Details:
GEDV Monkstown Owner Limited, 3rd Floor
Kilmore House, Park Lane, Spencer Dock,
Dublin 1.

Project Details:
**Dalguise
Monkstown**

Job No.	Sheet Size:	Scale @A1:	Status	Purpose of Issue
P21-066D	A1	1:500	P01	PLANNING PERMISSION
Issue Date:	Drawn By:	Reviewed By:	Revision	
12/10/22	MG	EOB	MKS-RAU-ZZ-2-DR-AR-050	P01